

# Operating Instructions

## OptoLineDriver OLD6000 Type: 4600-0263



## Introduction

Read carefully through this instruction. With damages, that through non-observance of the Instruction caused, the warranty claim goes out. For consequence damages, that result from it, we don't take over any liability!

## Contents

Operating condition / Safety	1
Intended use	2
Product Description	3
Operation of the device	4
Declaration of conformity/Maintenance	4
Technical Data	4
Disorder	5
Guarantee	5
Disposal	5

## Note!

The appliance has left the Factory in a safety-related perfect condition.  
To keep this condition, and to guarantee a safe operation, the user must read Security Hints and Warning Notes contained in this Guidance!

## **Intended use**

The OptoLineDriver OLD6000 is designed for the industrial use in dry areas.  
The OptoLineDriver OLD6000 may not use near possibly maturing or spurting liquids (for example Aquarium). Every Application deviant from it is not allowable.

Over it any other use is not their intended purpose. The User / Operator alone is liable for this resultant damages. Another use as pre-determined is not allowable!

The OptoLineDriver OLD6000 is allowed to described and anticipated use cases only in connection as well from the Manufacturer suggested or admitted foreign components uses.

Intended use includes compliance with all security hints and this belongs to due application allowable environment conditions and Specifications, that are defined for the appliance.

## **Operating conditions/Safety**

- Omit any manipulation or altering the OptoLine Driver OLD6000.
- Have repairs only by a qualified Electrician.
- Make sure, that the appliance doesn't reach into child hands.
- The operation of the device may occur only with the provided power adapter.
- It is absolutely necessary to regard the Compliance with the specifications in this guidance.
- The device is only for use in dry and clean areas.
- The device may only under supervision of a competent adults or an expert in taken to Operation!
- In Industrial facilities are the accident prevention rules of the association of this commercial Industrial professional associations for electric installations and operating resources.
- In case the appliance must be repaired, only original spare parts allowed to use!
- The Application of variant spare parts can lead to serious damage to property and persons!
- A repair of the appliance may only allowed from authorized Specialist.
- It must be generally tested before implementing the device, whether in principle the use case for which it should be used, suitable is! In the case of doubt it is necessarily queries with Professionals, experts or the Manufacturer!

Please note that serves and connection mistakes are outside our Sphere of influence Understandably, we can take over no liability for damages, that are created from it.

## Product Description

The OptoLineDriver OLD6000 is an Ethernet-coupling Device with galvanic separation and do be used for the protection against surges and lightning events.

Network Insulator with galvanic separation and active protection circuit at lightning events. The protection system uses an optical bridge to avoids lightning damages and breakdowns.

The Interface at use in existing networks with conventional wiring becomes through an optical bridge connected and galvanic insulates - ideally with different potentials at transmit - and receive-places. Furthermore, the optical transfer is immune against the scatter electromagnetic disturbances. These occur in sales areas and installations, for example, in those appliances like cool aggregates and discharge lamps are driven or external sturgeon - Events can appear.

- Existing networks with conventional wiring simply can in between plugging with a optical data coupling retrofitted
- Immune to interference, galvanically isolated, large distances (90 m)
- Spread of electromagnetic interference is prevented by optical coupling with simultaneous galvanic isolation
- Lightning protection for existing devices: Back Office PC/network technology is 100% protected against over-voltage 6 kV (1.2/50  $\mu$ s) on the Ethernet cable to prevent any damage

### Network technology is 100% protected against over-voltage 6kV (1.2/50 $\mu$ s) on the Ethernet cable to prevent any damage.

- OptoLineDriver OLD6000 combines 100BaseTX/FX and 100BaseTX/FX
- Point-to-point transparent mode LAN: RJ45
- Supports IPv4 and IPv6 data transport
- Display LEDs for power status
- Can be used as a repeater for signal regeneration for cable lengths greater than 90 metres
- OptoLineDriver OLD6000 can be combined with Longlife Power Protection ÜSG 650W
- Powered by external 5 V power adapter (included)
- Extremely compact - only 125 x 80 x 50 (W x H x D in mm, without connections / mounting brackets)

## Application scheme

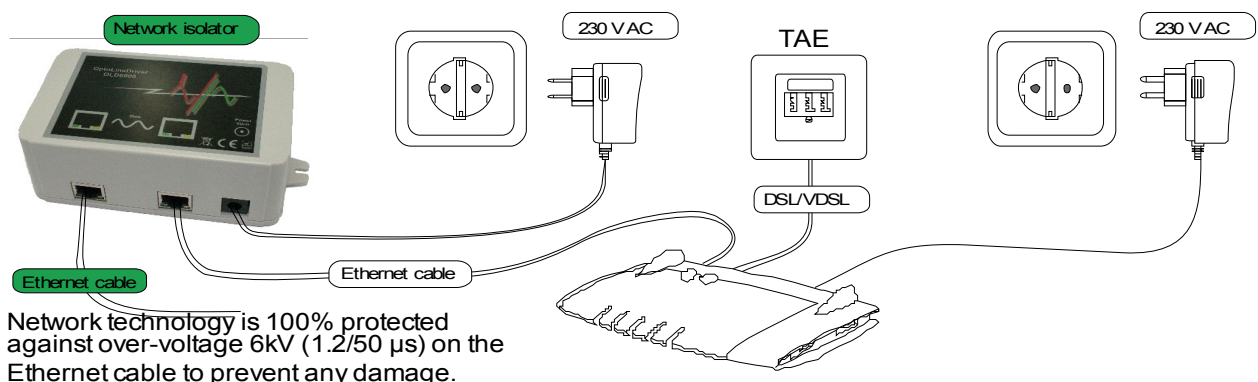

## Declaration of Conformity

The CE became in agreement with the following European guidelines - signs installed:

- 2006/95/EC Low voltage guideline
- 2011/65/EU
- 2004/108/EC EMC Directive

With due Application the basic requests the guideline 2006/95/EG, 2011/65/EU and 2004/108/EG corresponds.

The conformity explanation is deposited by the Manufacturer

## Manufacturers

HWU electronics Ltd., Hamburger Street 50, D-46145 Oberhausen

## Maintenance and cleaning

The appliance "OptoLineDriver OLD6000 " is Maintenance-free.

## Technical data

Performance:	external
Technology:	Network Isolator Galvanic Isolation
Test regulation:	EN 55022:2010 + EN 55024:2010 + EN 50581 : 2012
Ambient temperature:	-10°C to +55°C, 10 to 90% relative air humidity (not condensing)
Case / Colour:	ABS / Light Gray RAL 7035
Dimensions:	Extremely compact - only 125 x 80 x 50 (W x H x D in mm, without Ab connections / mounting brackets)
Protection fo the enclosure:	IP-20
RoHS:	compliant
GTIN:	4280001059207
Tarifnummer:	85176200

## Scope of supply

External 5V power supply Connector  
Mounting Kit  
User Manual

## Logistics data

Width: 125 mm  
Height: 80 mm  
Depth: 50 mm  
Product weigt: 0,312 kg

## Disorder

To accept, that a functional operation is no longer possible, the device must be taken out of service

This applies:

- if the appliance shows visible damages
- if the appliance is no more able to function, no data transfer
- if parts of the appliance get rid or loose
- if operating voltage out of stock or data line defect

If the appliance must be repaired, only original spare parts can be used!

The application of deviant spare parts can lead to damages!

A repair of the appliance can be performed only by one authorized compartment business.

## Guarantee

On this appliance, we grant 24 months of guarantee. The guarantee includes the free removal of failings, that traceable used dodgy material at the application, or on manufacturing defects leading back.

## Disposal



### **Do not dispose of electrical appliances together with household waste!**

According to the European Directive 2002/96/EC on waste electrical and electronic equipment, used electric equipment should be disposed of separately and environmentally friendly recycled. For information on the disposal of old equipment please contact your local authority.

Regarding that of use for the first time with merchandise at private Consumers our Business has submitted sale packages for itself to the guarantee of this Fulfillment of our legal duties after § 6 VerpackV him/it nationwide transacts Retraction system of the Landbell INC., Mainz, connected. Further Information on the Website of the Landbell INC.



## Customer Support



### HWU Elektronik GmbH

Hamburger Straße 50 • D-46145 Oberhausen • Tel.: +49 (0)2 08 / 61 18 18  
Fax.: +49 (0)2 08 / 61 18 19 • Mail: [office@hwu.de](mailto:office@hwu.de) • Internet: [www.hwu.de](http://www.hwu.de)  
GLN: 4280001059009 • WEEE-Reg.-Nr.: DE 64690290

## Imprint

This Instruction manual is a printing of the HWU electronics Ltd., Hamburger Street 50, D-46145 Oberhausen.

All rights including translation reserve.

This Instruction manual corresponds to the technical stand at printing.

Alteration of technology and provision reserve.

© copyright 2015 by HWU electronics Ltd.